

Oil Level Indicator and Tube

Material

Item	Specification
Motorcraft® SAE 5W-20 Premium Synthetic Blend Motor Oil XO-5W20-QSP (US); Motorcraft® SAE 5W-20 Super Premium Motor Oil CXO-5W20-LSP12 (Canada); or equivalent	WSS-M2C930-A

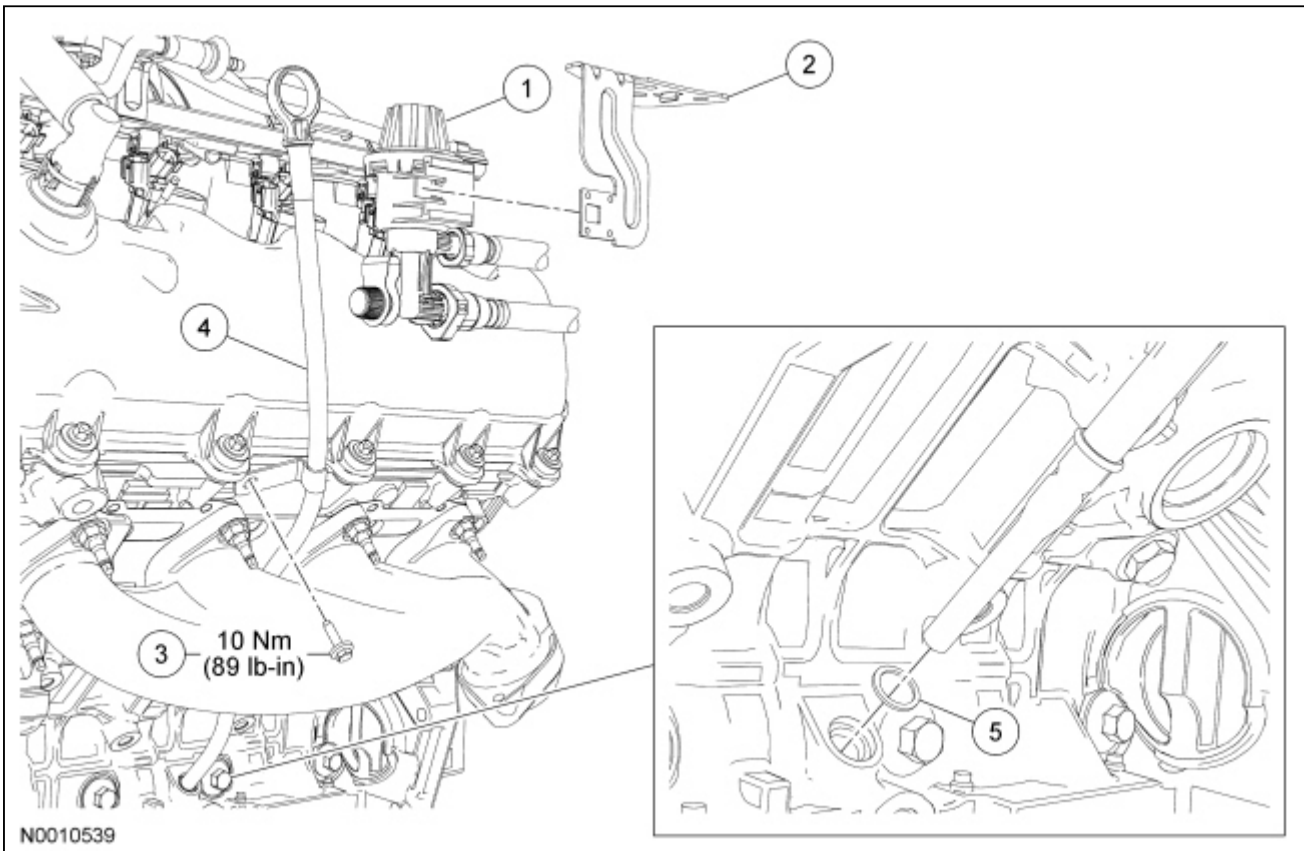

Item	Part Number	Description
1	9G641	Evaporative Emission (EVAP) canister purge valve
2	—	EVAP canister purge valve bracket (part of 9G641)
3	N605891	Oil level indicator and tube bolt
4	6754	Oil level indicator and tube
5	—	O-ring seal

Removal and Installation

1. With the vehicle in NEUTRAL, position it on a hoist. For additional information, refer to [Section 100-02](#).
2. Detach the Evaporative Emission (EVAP) canister purge valve from the bracket and position aside.
3. Remove the oil level indicator and tube bolt.
 - To install, tighten to 10 Nm (89 lb-in).

4. Remove the oil level indicator and tube from the cylinder block.
 - Discard the O-ring seal.
5. **NOTE:** Lubricate the new oil level indicator tube O-ring seal with clean engine oil prior to installation.

To install, reverse the removal procedure.
